

Congratulations!

With your purchase of this Premium Entrance Set, you are among a group of discerning individuals who know the intrinsic value of selecting the finest—Baldwin.

Our step-by-step installation instructions will help guide you through your project quickly and easily.

Before you begin your installation, read and understand the installation instructions and marking templates. If you have any questions, please do not hesitate to contact our **Baldwin Consumer Help Line at 1-800-566-1986**. We're here to help! We thank you for your purchase and wish you the fullest enjoyment of your Baldwin product.

Care and Maintenance

WARNING: Do not attempt to clean your hardware with any type of abrasive cleaners, solvents, or chemicals. These types of cleaning agents may mar the finish. A damp cloth is all that is necessary to wipe clean. Note: Finish Number 102, Oil-Rubbed Bronze, can be cleaned with light machine oil and wiped with a dry cloth.

Warranty

Refer to www.BaldwinHardware.com for a complete warranty statement.

BEFORE YOU BEGIN

- Remove and discard all materials and screw(s) used for packing your Premium Handleset. Verify that you have all parts pictured on exploded view section of instructions.
- Check door thickness. This lockset works on doors 1-3/4" thick only. For doors greater than 1-3/4" up to 2-1/4" thick, you will need to order a thick door conversion kit from any Baldwin Hardware dealer. The conversion kit part number for this item is 5399.XXX.C; please specify the finish of your product.
- Follow the step-by-step sequence to ensure proper operation of your Baldwin lockset.
- If your door is pre-drilled, skip Door Preparation.
- The illustrations in these instructions depict the outside handle being installed on the right of the door. For installation of the outside handle on the left of the door, proceed as if all illustrations were reversed.
- We recommend spreading cardboard over floor to prevent scratching parts and marring floor.
- Always wear protective eye wear.



Consumer Help Line

If you have trouble installing your Baldwin product, feel free to call our toll-free Consumer Help Line:
1-800-566-1986

Hours:

8 a.m. to 6 p.m. E.S.T. - Monday through Friday
9 a.m. to 5 p.m. E.S.T. - Saturday

DUMMY HANDLESET: EXPLODED VIEW

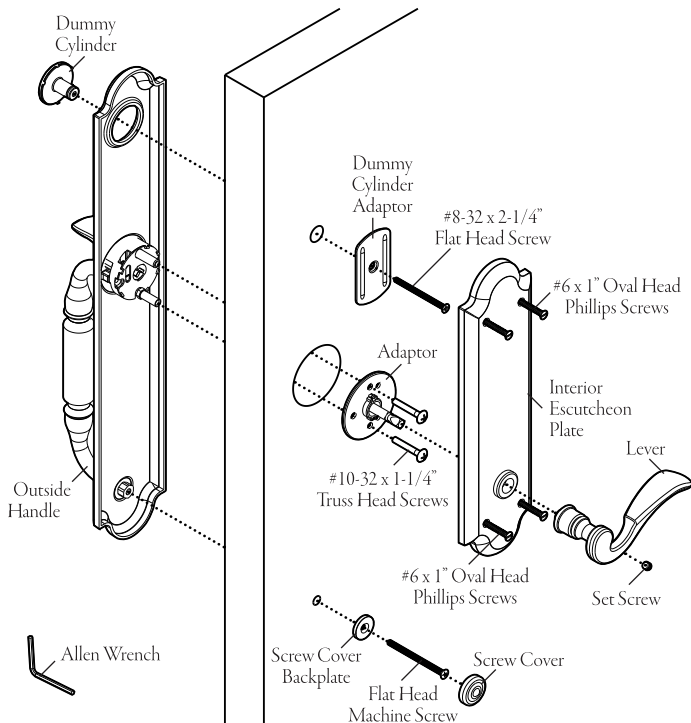

DUMMY HANDLESET: DOOR PREPARATION

1. Fold the enclosed template on the line and position it on the door at the specified height.

Non-bored Doors - Determine your door thickness and type of handleset to be installed. Measure the height and backset of the active trim, using the enclosed template to locate and mark the required holes (A, B, C) for drilling. Ensure the backset and height match the active trim. Hole A should be 38" from the floor. Proceed to Step 2.

Bored Doors - Mark and drill hole C (5/16") for appropriate handleset design. Proceed to Step 1 of Dummy Trim: Installation.

Beveled Doors - Place the folded edge of the template on the low side of the bevel as shown below.

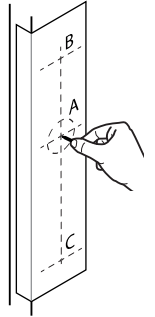
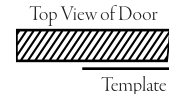

2. Drill the 2-1/8" diameter face bore (A) through the door matching the backset of the active trim (2-3/8" or 2-3/4"). Drill the 1/2" dummy cylinder hole (B) through the door at same backset as hole A. Drill the 5/16" lower pull assembly hole (C) for the appropriate handleset shown on template.

Caution: Re-check hole locations before drilling.

- A - 2-1/8"
- B - 1/2"
- C - 5/16" Drill for proper handleset

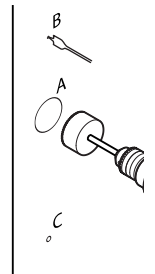

DUMMY HANDLESET: INSTALLATION

1. Place handleset against outside of door and attach with #10-32 x 2-1/2" flat head machine screw. Tighten the screw enough to hold handleset in place but not fully tightened.

Attach the adaptor with two #10-32 x 1-1/4" truss head screws.

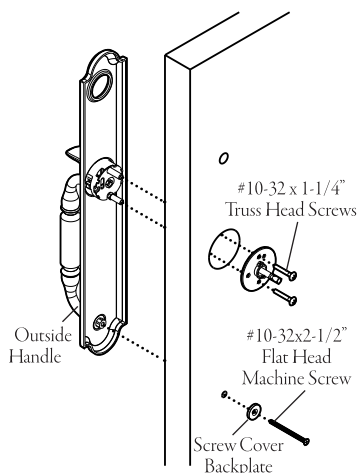

2. Place the dummy cylinder into the cylinder hole of the outside handle. Insert one #8-32 x 2-1/4" flat head screw through the dummy cylinder adaptor and into the dummy cylinder. Tighten all the screws.

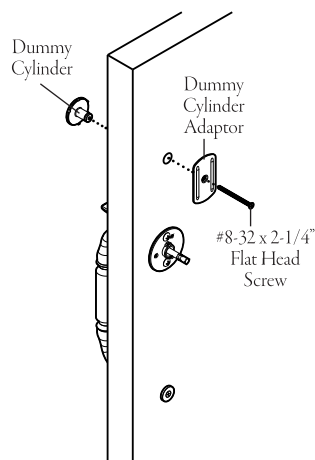

3. Place the interior escutcheon plate over the adaptor and slide the lever onto the adaptor. Ensure that the interior escutcheon plate edge is parallel to the door edge, then mark the screw hole locations. Remove the lever and interior escutcheon plate. With a 1/16" drill bit, drill the pilot holes. Attach the screw cover.

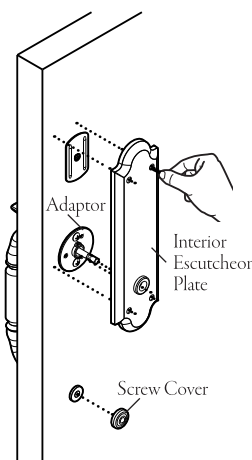

4. Reinstall the interior escutcheon plate with four #6 x 1" oval head phillips screws. Slide the lever onto the adaptor and secure with the set screw.

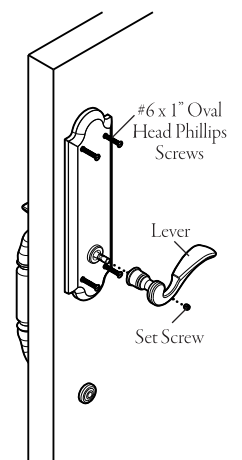

ACTIVE HANDLESET: EXPLODED VIEW

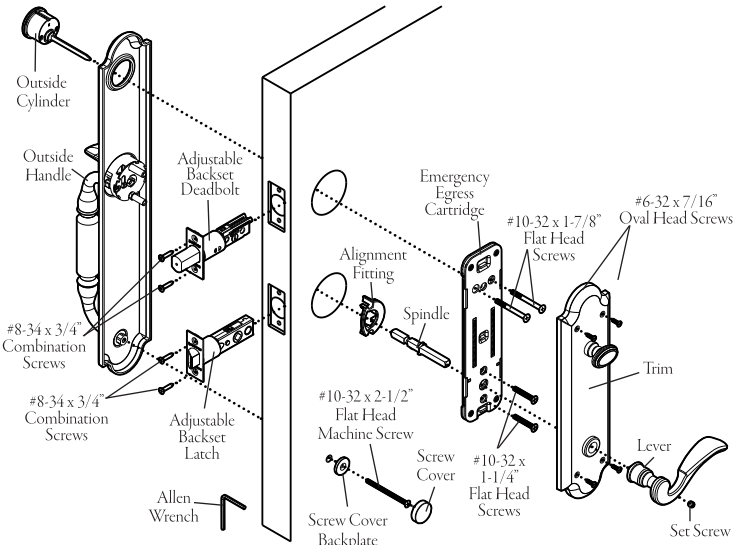

ACTIVE HANDLESET: DOOR PREPARATION

1. Fold the enclosed template on the line and position it on the door at the specified height.

Non-bored Doors - Determine your door thickness and type of handleset to be installed. Locate and mark the required holes (A, B, C, D, E) for drilling. Hole A should be 38" from the floor. Proceed to Step 2.

Bored Doors - Mark and drill hole E (5/16") for appropriate handleset design. Proceed to Step 1 of Active Trim Installation.

Beveled Doors - Place the folded edge of the template on the low side of the bevel as shown below.

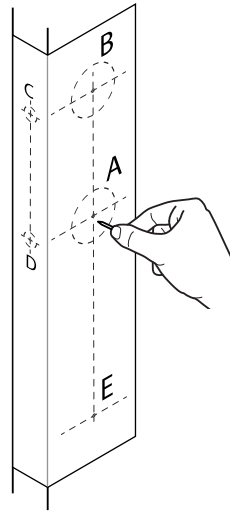
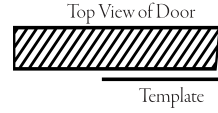

ACTIVE HANDLESET: DOOR PREPARATION (CONTINUED)

2. Drill the 2-1/8" diameter face bore (A and B) through the door and 1" diameter edge bores (C and D) 3-1/2" deep for 2-3/8" backset or 3-7/8" deep for 2-3/4" backset. The latch and deadbolt accommodates both size backsets. Drill the 5/16" lower pull assembly hole (E) for the appropriate handleset shown on template.

Caution: Re-check hole locations before drilling.

A - 2-1/8" D - 1"
B - 2-1/8" E - 5/16" Drill for proper handleset.
C - 1"

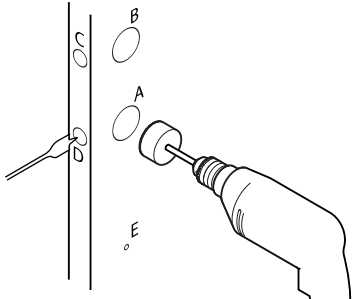

3. Insert deadbolt into edge of door. While holding faceplate parallel to edge of door, trace an outline of the faceplate onto the door edge. Mark screw hole centers and drill 1/8" pilot holes. Remove deadbolt and repeat process for latch.

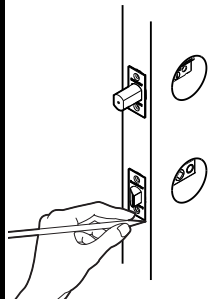

4. Chisel out area marked in Step 3 to a depth of 5/32" or until faceplate is flush with door edge.

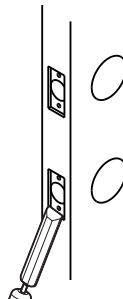

ACTIVE: LATCH INSTALLATION

1. The latch and deadbolt supplied with this unit has an adjustable backset feature. They will be set at 2-3/8" backset. To adjust to 2-3/4" backset, grasp body and twist faceplate/bolt head assembly 180° until it stops. Unit is now ready for installation in 2-3/4" backset configuration.
2. Position deadbolt and latch. Install with four #8 x 3/4" flat head combination screws provided (see diagram for proper positioning). Manually extend the deadbolt from the edge of the door using a flathead screwdriver.

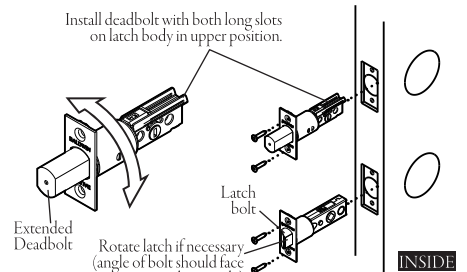

ACTIVE: HANDLESET INSTALLATION

1. Place handleset against outside of door and attach by fastening the #10-32 x 2-1/2" flat head screw through the screw cover back and lower hole, tighten screw enough to hold handleset in place.

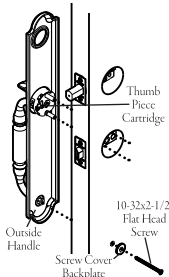

2. From inside of door, slide alignment fitting between the post and around the latch as illustrated.

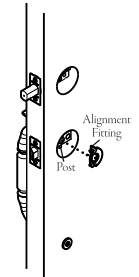

3. Measure the thickness of your door. If door is less than 1-3/4" thick, do not use the flat spacer provided. If your door measures 1-3/4", slide the spacer onto the spindle as shown in the diagram.

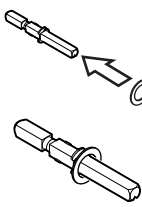

4. From inside of door, insert short end of spindle through the latch with the "V groove" angled down and toward the hinges. Verify deadbolt is extended.

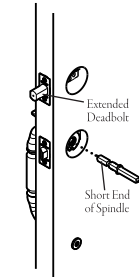

5. For assembling with an interior "LEVER," slide "LEVER STRENGTH" egress cartridge onto spindle.

For assembling with an interior "KNOB," slide "KNOB STRENGTH" egress cartridge onto spindle.

Attach lower portion of cartridge to handleset with two #10-32 x 1-1/4" flat head machine screws. Do not tighten screws at this time.

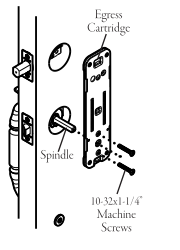

6. Rotate deadbolt cam towards door edge using flat head screwdriver. This will cover the mounting screw hole that is closest to the door edge.

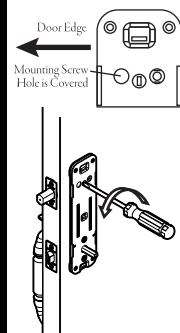

7. Keeping cylinder tailpiece in vertical position, insert tailpiece through outside handleset assembly, deadbolt and Emergency Egress cartridge. From the inside of door, rotate the tailpiece back to retract the deadbolt, then attach the cylinder with two #10-32 x 1-7/8" flat head machine screws. Make certain your handleset operates correctly and is properly aligned, then tighten all screws.

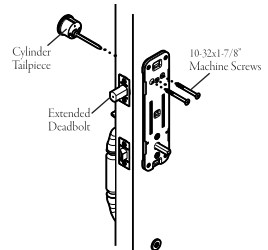

ACTIVE: CONTINUED

8. Align the slot in turn knob with cylinder tailpiece and place against door. Fasten trim with four #6-32 x 7/16" oval head screws. Caution: Do not over tighten screws. Tighten #10-32 x 2-1/2" flat head screw then attach screw cover.

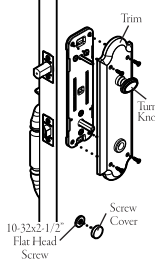

9. Pull spindle out as far as possible and depress thumb piece. With thumb piece depressed, slide lever/knob onto spindle and tighten set screw (with allen wrench supplied) firmly into "V" groove.

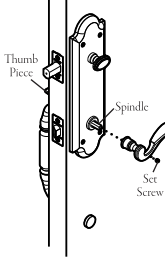

ACTIVE: STRIKE INSTALLATION

1. Using strike marking template, locate and mark strike mounting screws and centering points for both strikes at required door thickness. Note: for double doors, the strikes will be located on the non-active door.

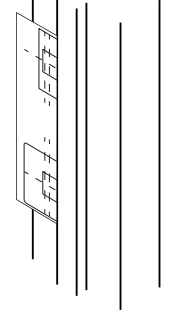

2. Align and trace outline of strikes onto the door frame using mounting screw marks for location.

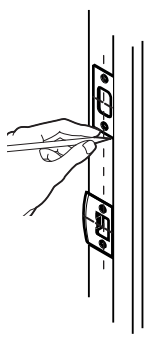

3. Deadbolt strike: Using reinforcing strike as template, mark locations for reinforcing screws (Fig. 1). Drill two 5/32" dia. pilot holes for the 3" long screws and two 1/8" dia. pilot holes for the #8 x 3/4" screws. Bore 7/8" dia. x 3/4" deep hole in the center of the strike.

Latch strike: At previously marked locations, drill two 1/8" dia. pilot holes for the #8 x 3/4" screws. Bore 7/8" dia. x 3/4" deep hole in the center of the strike.

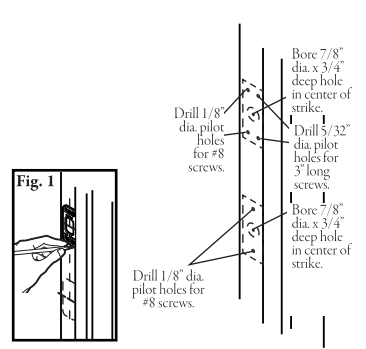

4. Deadbolt strike: 7/32" deep or until the strike box, reinforcing strike, and strike plate fits inside mortise and flush with the door frame.
- Latch strike: 3/32" deep or until strike box and strike fit inside mortise and flush with the door frame.

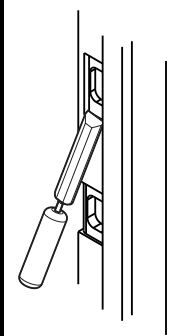

5. Install strikes as illustrated.
 1. Dust Box (deadbolt)
 2. Reinforcing Strike
 3. #8 x 3/4" Combination Screws
 4. 3" Reinforcing Screws
 5. Strike Plate (deadbolt)
 6. #8-32 x 1/4" Machine Screws
 7. Dust Box (latch)
 8. Strike (latch)
 9. #8 x 3/4" Wood Screws

NOTE: Lubricant recommended when installing 3" reinforcing screws.

